

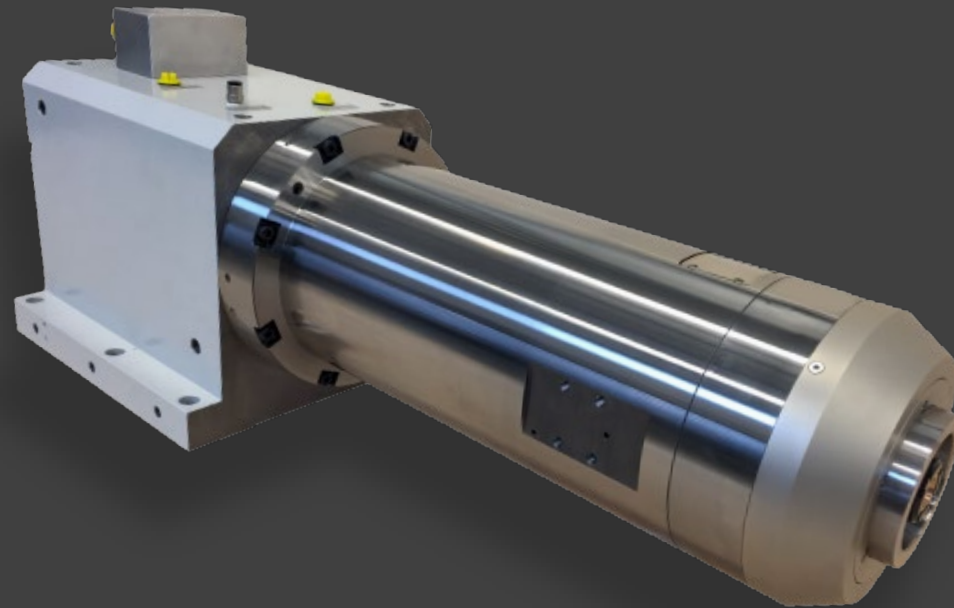

Precision Spindles &  
Spindle repair services

[myl.es](http://myl.es)

# Grinding Spindles Model Range





# Standard Vertical Grinding Spindles

|                            |                 |                 |                 |                 |                 |                 |                 |                 |                 |                 |                 |                 |                 |
|----------------------------|-----------------|-----------------|-----------------|-----------------|-----------------|-----------------|-----------------|-----------------|-----------------|-----------------|-----------------|-----------------|-----------------|
| Housing Diameter D         | 150             | 180             | 180             | 180             | 180             | 180             | 180             | 200             | 200             | 200             | 200             | 200             | 200             |
| Housing Length L           | 400             | 200             | 200             | 200             | 400             | 400             | 400             | 600             | 600             | 800             | 800             | 800             | 800             |
| ATC                        | Yes             | No              | No              | Yes             | No              | No              | Yes             | Yes             | Yes             | Yes             | Yes             | Yes             | Yes             |
| Interface                  | HSK-A63         | HSK C100        | CTE             | HSK-A100        | HSK C100        | CTE             | HSK-A100        | HSK-A100        | HSK-A100        | HSK-A100        | HSK-A100        | HSK-A100        | HSK-A100        |
| Turning lock               | No              | No              | No              | No              | No              | No              | No              | No              | Yes             | No              | Yes             | No              | Yes             |
| Gap/Crash                  | AE Sensor       | AE Sensor       | AE Sensor       | AE Sensor       | AE Sensor       | AE Sensor       | AE Sensor       | AE Sensor       | AE Sensor       | AE Sensor       | AE Sensor       | AE Sensor       | AE Sensor       |
| Motor                      | Asynchronous    | Asynchronous    | Asynchronous    | Asynchronous    | Asynchronous    | Asynchronous    | Asynchronous    | Asynchronous    | Asynchronous    | Asynchronous    | Asynchronous    | Asynchronous    | Asynchronous    |
| Power (kW) @ Speed (1/min) | 15 @ 2200       | 21 @ 1550       | 21 @ 1550       | 21 @ 1550       | 21 @ 1550       | 21 @ 1550       | 21 @ 1550       | 21 @ 1550       | 21 @ 1550       | 15 @ 2200       | 15 @ 2200       | 15 @ 2200       | 15 @ 2200       |
| Speed max (1/min)          | 6000            | 5500            | 5500            | 5500            | 5500            | 5500            | 5500            | 6000            | 6000            | 6000            | 6000            | 9000            | 9000            |
| Balancing (*)              | Semi-automatic  | Auto: BS        | Auto: BS        | Semi-automatic  | Auto: BS        | Auto: BS        | Semi-automatic  | Semi-automatic  | Semi-automatic  | Semi-automatic  | Semi-automatic  | Semi-automatic  | Semi-automatic  |
| Dimensiones muela          | 350x80          | 350x120         | 350x120         | 350x120         | 350x120         | 350x120         | 350x120         | 350x80          | 350x80          | 350x80          | 350x80          | 350x80          | 350x80          |
| Máquina                    | VG800           | VG800/VG1500    | VG800/VG1500    | VG800/VG1500    | VG800/VG1500    | VG800/VG1500    | VG800/VG1500    | VG1500          | VG1500          | VG1500          | VG1500          | VG1500          | VG1500          |
| OPTIONS                    | #1 #4 #7        | #8 #9           | #8 #9           | #1 #3 #6        | #3 #9           | #8 #9           | #1 #3 #6        | #1 #3 #6        | #1 #3 #6        | #1 #3 #6        | #1 #3 #6        | #1 #3 #6        | #1 #3 #6        |
| MYL CODE                   | SP02GE011000108 | SP02GE011000128 | SP02GE011000127 | SP02GE011000141 | SP02GE011000126 | SP02GE011000125 | SP02GE011000136 | SP02GE011000142 | SP02GE011000143 | SP02GE011000105 | SP02GE011000107 | SP02GE011000144 | SP02GE011000145 |

|           |                                     |
|-----------|-------------------------------------|
| OPTION #1 | Balancing pack                      |
| OPTION #2 | AE Sensor BS Ø200                   |
| OPTION #3 | AE Sensor BS Ø180                   |
| OPTION #4 | AE Sensor BS Ø150                   |
| OPTION #5 | AE Sensor Dittel Ø200               |
| OPTION #6 | AE Sensor Dittel Ø180               |
| OPTION #7 | AE Sensor Dittel Ø150               |
| OPTION #8 | Balancing pack without speed sensor |
| OPTION #9 | AE Sensor BS Ø50                    |

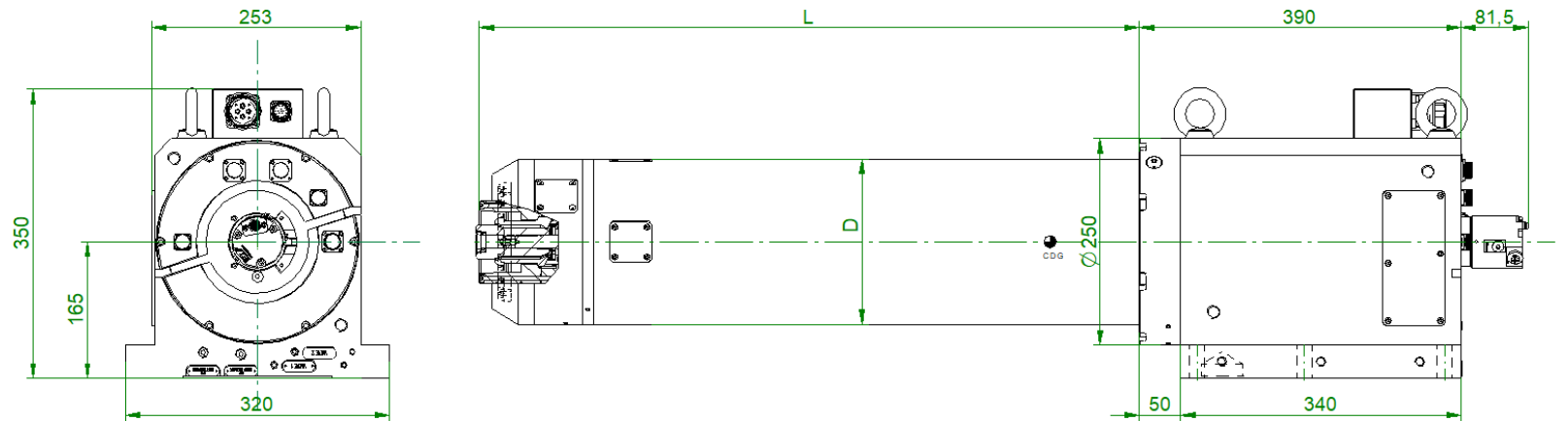



# Standard Horizontal ID Grinding Spindles

|                 | A   | B   | C   | D max | E max | TAPER 1/7.5 | MAX SPEED |
|-----------------|-----|-----|-----|-------|-------|-------------|-----------|
| SP14GE011000124 | 40  | 250 | 377 | 80    | 20    | Ø13.5       | 16.000    |
| SP14GE011000125 | 50  | 300 | 427 | 90    | 25    | Ø13.5       | 11.000    |
| SP14GE011000126 | 60  | 350 | 477 | 100   | 25    | Ø23         | 10.000    |
| SP14GE011000127 | 70  | 400 | 527 | 125   | 32    | Ø28         | 9.000     |
| SP14GE011000128 | 80  | 500 | 627 | 125   | 32    | Ø28         | 8.000     |
| SP14GE011000129 | 100 | 600 | 727 | 150   | 40    | Ø38         | 7.500     |

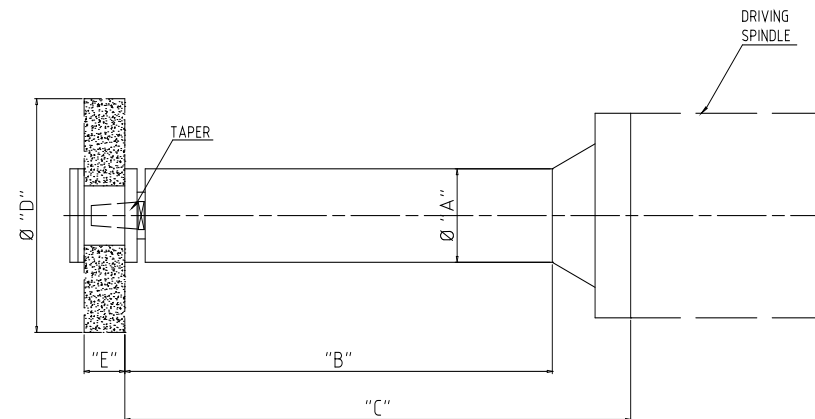



# Horizontal Grinding Spindle Driving System

|                           |                 |
|---------------------------|-----------------|
| MYL CODE                  | SP02GE011000123 |
| DIMENSIONS [mm]           | 171x186         |
| WORKING POSITION          | HORIZONTAL      |
| MOTOR TYPE                | ASYNCHRONOUS    |
| TORQUE [Nm] @ SPEED [rpm] | 27.5 @4,500     |
| POWER [kW] @ SPEED [rpm]  | 13 @4,500       |
| MAX SPEED [rpm]           | 20,000          |
| INTERFACE                 | HSK – C63       |
| LUBRICATION               | GREASE          |
| ATC                       | NO              |

|                               |     |
|-------------------------------|-----|
| BEARING T <sup>º</sup> SENSOR | YES |
| AIR SEAL                      | YES |

|               |
|---------------|
| OPTIONS       |
| ACCELEROMETER |
| ENCODER       |
| SPEED SENSOR  |

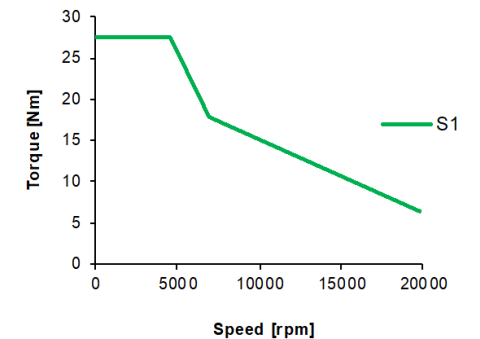
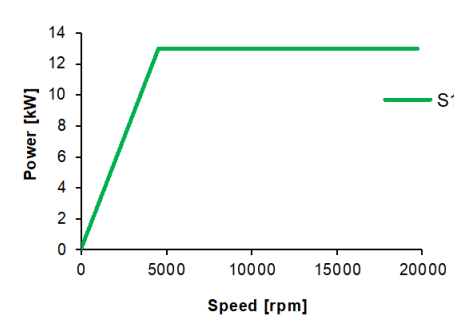
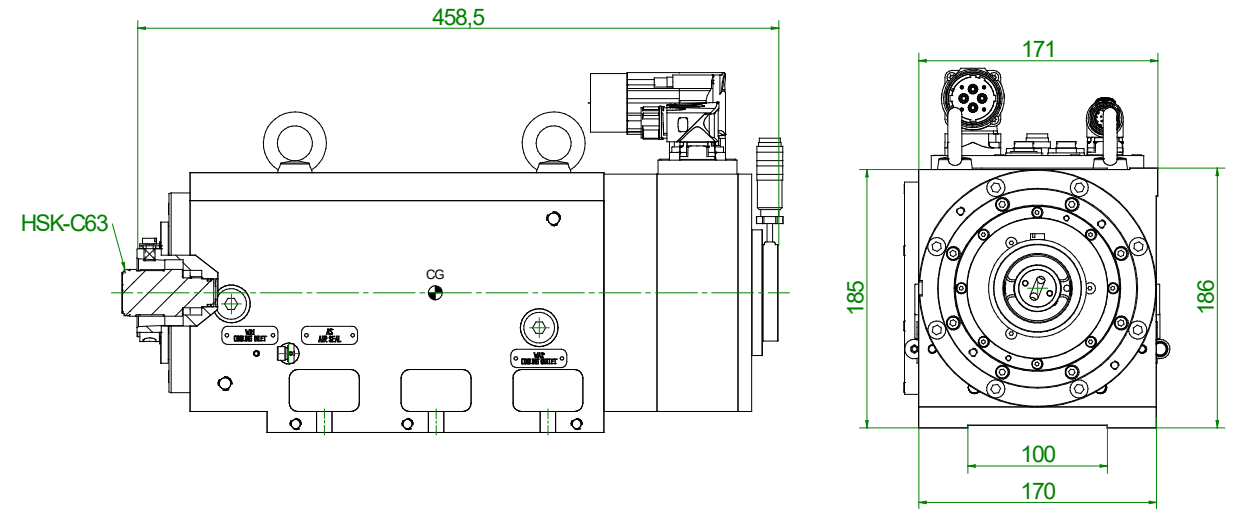



# SGV 32kW 6000rpm SK40 Dynamic Balancer

|                           |                 |
|---------------------------|-----------------|
| MYL CODE                  | SP02GE011000078 |
| DIMENSIONS [mm]           | 380x432         |
| WORKING POSITION          | VERTICAL        |
| MOTOR TYPE                | ASYNCHRONOUS    |
| TORQUE [Nm] @ SPEED [rpm] | 200 @ 1,500     |
| POWER [kW] @ SPEED [rpm]  | 31.5 @ 1,500    |
| MAX SPEED [rpm]           | 6,000           |
| TAPER TYPE                | Ø83             |
| LUBRICATION               | GREASE          |
| ATC                       | YES             |

|                   |     |
|-------------------|-----|
| DYNAMIC BALANCER  | YES |
| BEARING Tº SENSOR | YES |
| ENCODER           | YES |
| AIR SEAL          | YES |

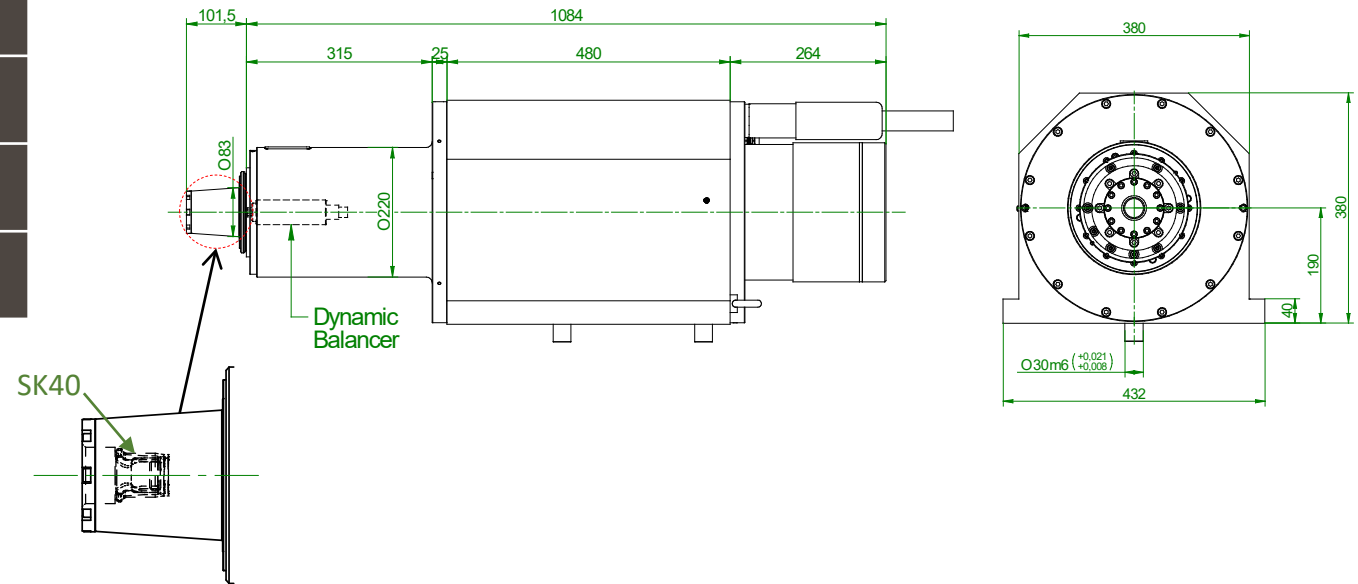

**NOTE:**  
Vertical grinding Electrospindle,  
with automatic grinding wheel  
changing system.  
Integrated Dynamic Balancer.

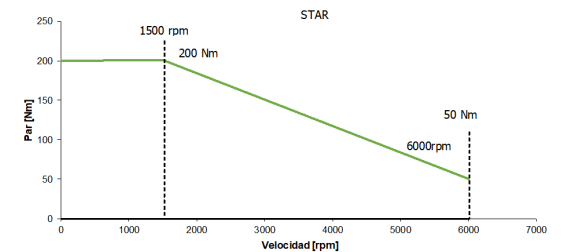
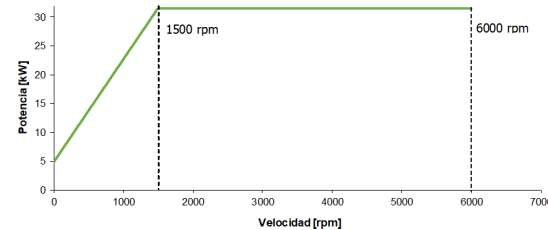



# SGV Ø200 L260 25kW 9000rpm HSK-100 RI

|                           |                       |
|---------------------------|-----------------------|
| MYL CODE                  | SP02GE011000092       |
| DIMENSIONS [mm]           | 320x285               |
| WORKING POSITION          | HORIZONTAL / VERTICAL |
| MOTOR TYPE                | ASYNCHRONOUS          |
| TORQUE [Nm] @ SPEED [rpm] | 108.5 @2,200          |
| POWER [kW] @ SPEED [rpm]  | 25 @2,200             |
| MAX SPEED [rpm]           | 9,000                 |
| INTERFACE                 | HSK – A 100           |
| LUBRICATION               | GREASE                |
| ATC                       | YES                   |

|                               |     |
|-------------------------------|-----|
| BEARING T <sup>º</sup> SENSOR | YES |
| ACCELEROMETER                 | YES |
| ENCODER                       | YES |
| SPEED SENSOR                  | YES |
| AE SENSOR                     | YES |
| INTERNAL COOLANT              | YES |
| AIR SEAL                      | YES |

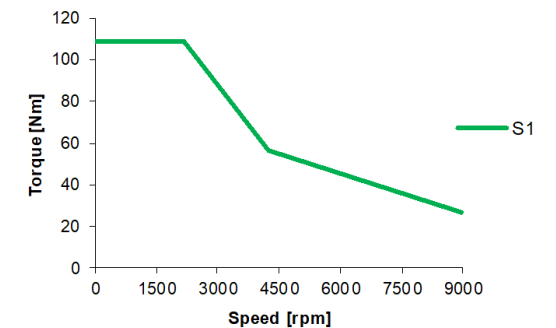
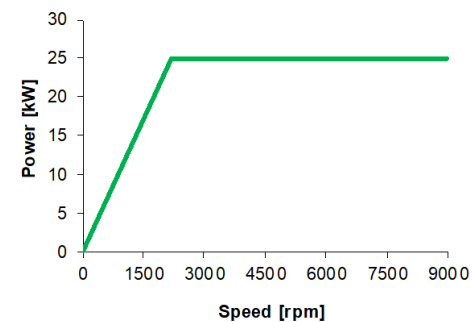
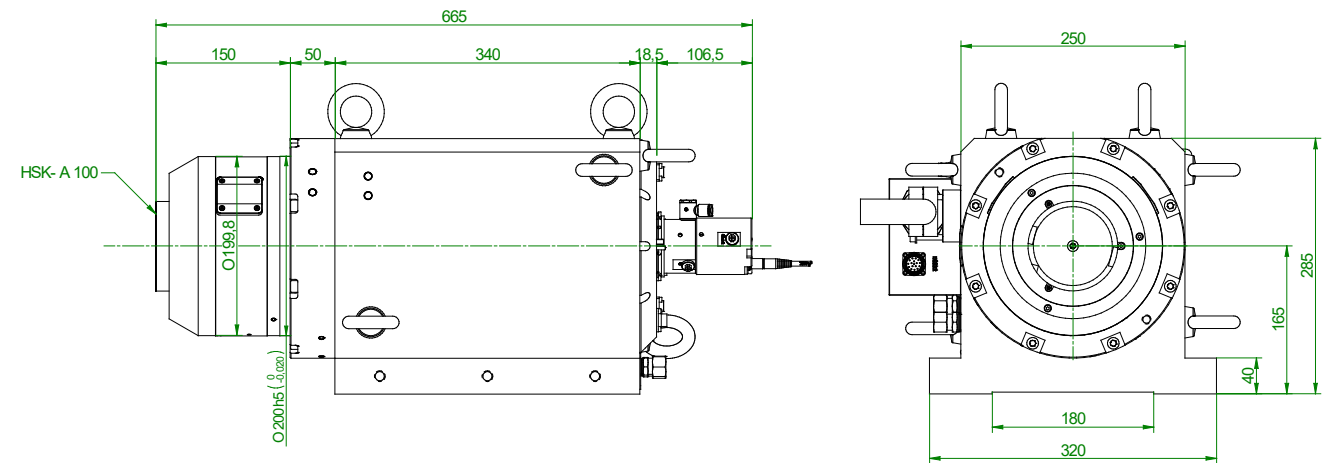



# SGV Ø270 L750 32kW 2500 rpm HD

|                           |                 |
|---------------------------|-----------------|
| MYL CODE                  | SP02GE011000201 |
| DIAMETER [mm]             | 375             |
| WORKING POSITION          | VERTICAL        |
| MOTOR TYPE                | ASYNCHRONOUS    |
| TORQUE [Nm] @ SPEED [rpm] | 303 @1,000      |
| POWER [kW] @ SPEED [rpm]  | 32 @1,000       |
| MAX SPEED [rpm]           | 2,500           |
| TAPER                     | Ø125 – 1/7.5    |
| LUBRICATION               | GREASE          |
| ATC                       | NO              |

|                              |                |
|------------------------------|----------------|
| GRINDING WHEEL DIAMETER [mm] | Ø600<br>H= 300 |
| BEARING T° SENSOR            | YES            |
| AIR SEAL                     | YES            |

|                    |
|--------------------|
| OPTIONS            |
| AUTOMATIC BALANCER |

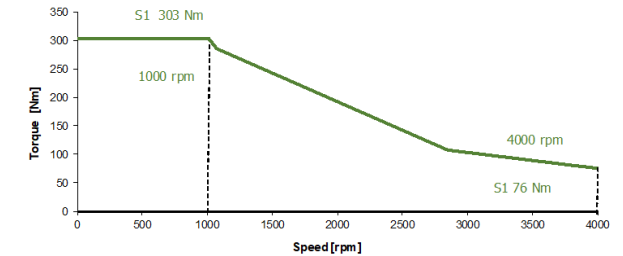
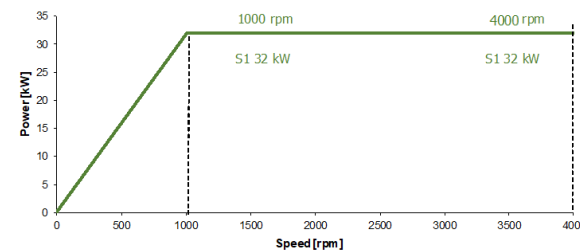
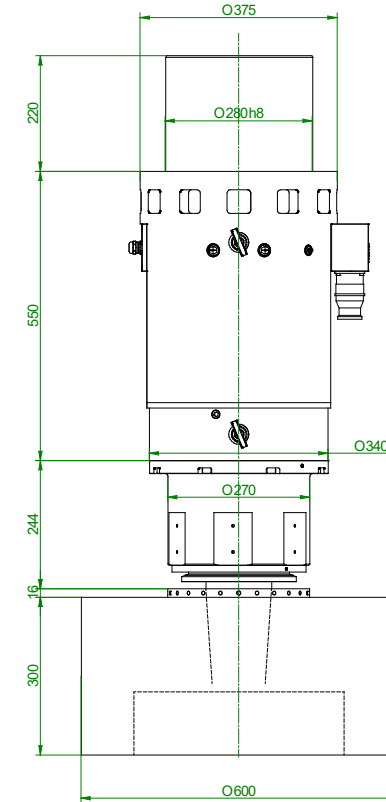



# SGV Ø220 5000rpm 35kW HSK-A100

|                           |                 |
|---------------------------|-----------------|
| MYL CODE                  | SP02GE011000174 |
| DIAMETER [mm]             | 220             |
| WORKING POSITION          | VERTICAL        |
| MOTOR TYPE                | ASYNCHRONOUS    |
| TORQUE [Nm] @ SPEED [rpm] | 184 @1,400      |
| POWER [kW] @ SPEED [rpm]  | 27 @1,400       |
| MAX SPEED [rpm]           | 5,000           |
| INTERFACE                 | HSK – A 100     |
| LUBRICATION               | GREASE          |
| ATC                       | YES             |

|                   |     |
|-------------------|-----|
| BEARING Tº SENSOR | YES |
| ACCELEROMETER     | YES |
| ENCODER           | YES |
| SPEED SENSOR      | YES |
| AIR SEAL          | YES |

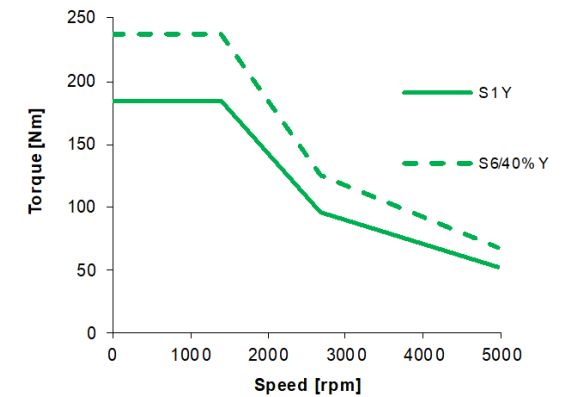
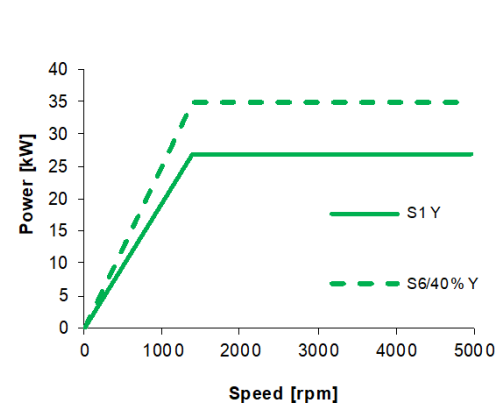
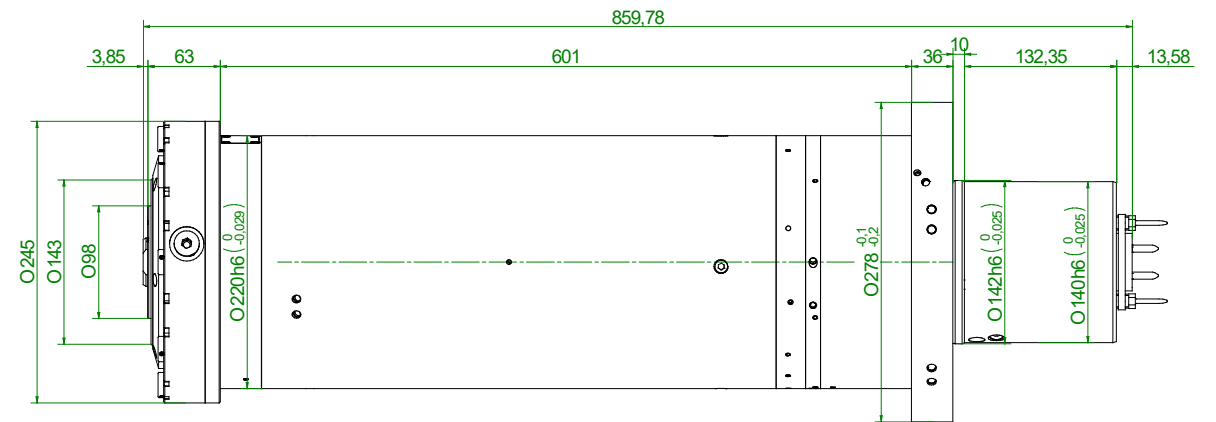





# SGV 250 36kW 10.000rpm HSK-A100

|                           |                 |
|---------------------------|-----------------|
| MYL CODE                  | SP02GE011000212 |
| DIMENSIONS [mm]           | 300x250         |
| WORKING POSITION          | VERTICAL        |
| MOTOR TYPE                | ASYNCHRONOUS    |
| TORQUE [Nm] @ SPEED [rpm] | 112 @2,500      |
| POWER [kW] @ SPEED [rpm]  | 30 @2,500       |
| MAX SPEED [rpm]           | 10,000          |
| INTERFACE                 | HSK – A 100     |
| LUBRICATION               | AIR-OIL         |
| ATC                       | YES (OPTIONAL)  |

|                   |     |
|-------------------|-----|
| BEARING T° SENSOR | YES |
| ENCODER           | YES |
| AIR SEAL          | YES |

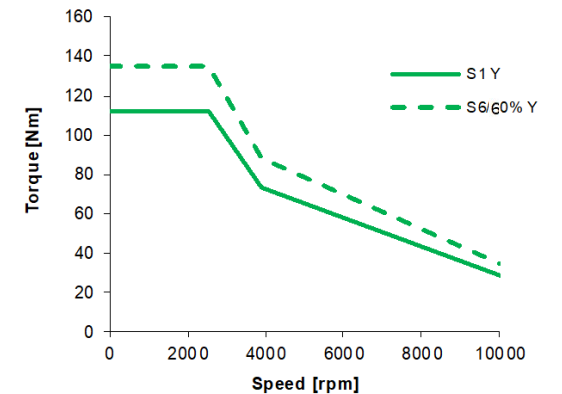
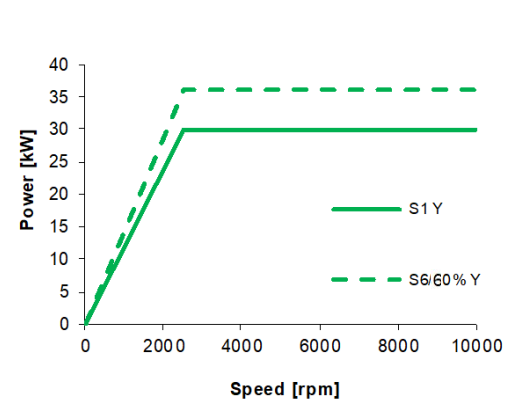
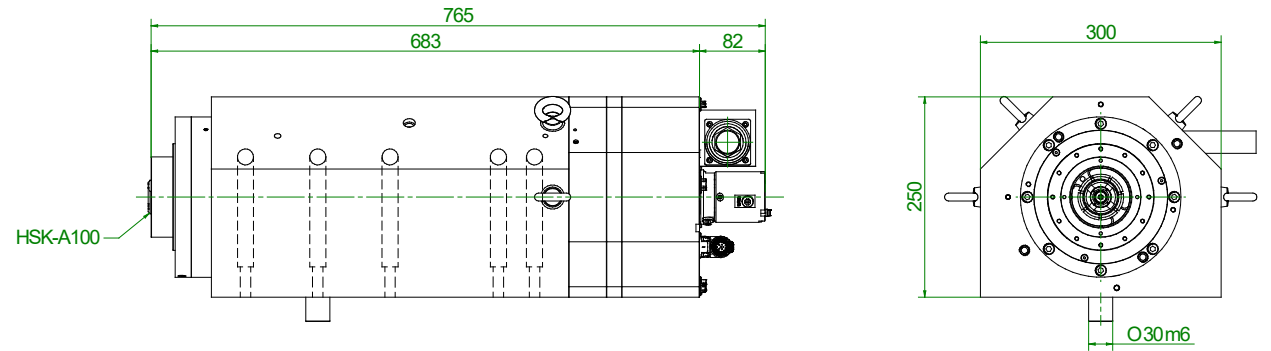



# SGE Ø28-355-22500/4

|                           |                 |
|---------------------------|-----------------|
| MYL CODE                  | SP02GE011000152 |
| DIAMETER [mm]             | 28              |
| WORKING POSITION          | HORIZONTAL      |
| MOTOR TYPE                | ASYNCHRONOUS    |
| TORQUE [Nm] @ SPEED [rpm] | 5 @7,700        |
| POWER [kW] @ SPEED [rpm]  | 4 @7,700        |
| MAX SPEED [rpm]           | 22,500          |
| TAPER TYPE                | Ø9 / 1:7.5      |
| LUBRICATION               | GREASE          |
| ATC                       | NO              |

|                   |     |
|-------------------|-----|
| BEARING Tº SENSOR | YES |
| OPTIONS           |     |
| SPEED SENSOR      |     |

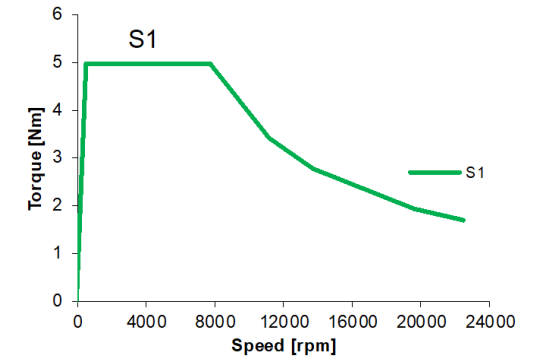
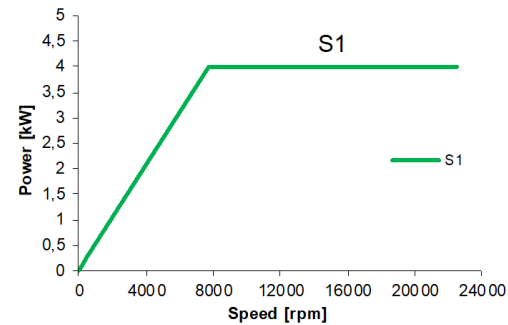
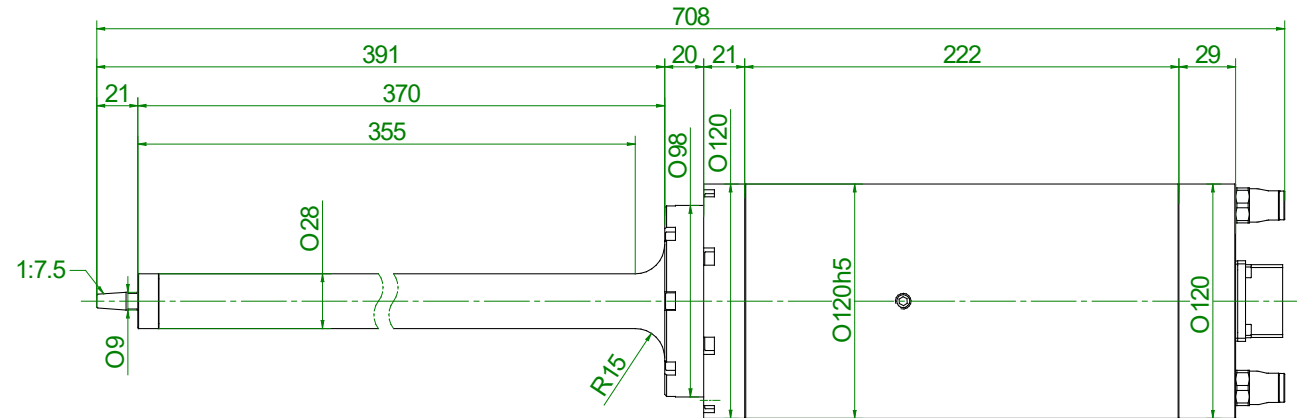



# SGP Ø150 30000rpm 21kW CW/CCW

|                              |                                    |
|------------------------------|------------------------------------|
| MYL CODE                     | SP15GE011000146<br>SP15GE011000147 |
| DIAMETER [mm]                | 150                                |
| WORKING POSITION             | VERTICAL<br>DOWNWARD               |
| MOTOR TYPE                   | ASYNCHRONOUS                       |
| TORQUE [Nm] @<br>SPEED [rpm] | 15 @13,800                         |
| POWER [kW] @<br>SPEED [rpm]  | 21 @13,800                         |
| MAX SPEED [rpm]              | 30,000                             |
| TAPER TYPE                   | Ø36 – M36x2                        |
| LUBRICATION                  | OILMIST                            |
| ATC                          | NO                                 |

|                      |     |
|----------------------|-----|
| BEARING Tº<br>SENSOR | YES |
| SPEED SENSOR         | YES |
| AIR SEAL             | YES |

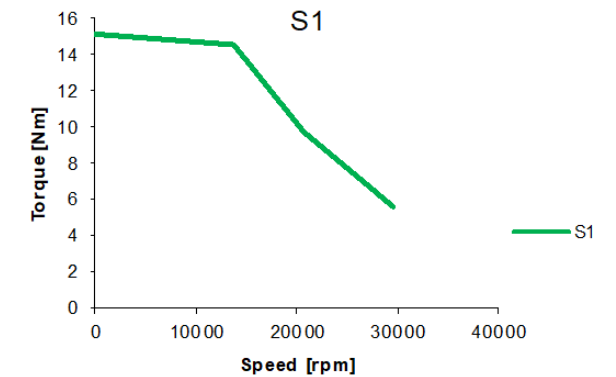
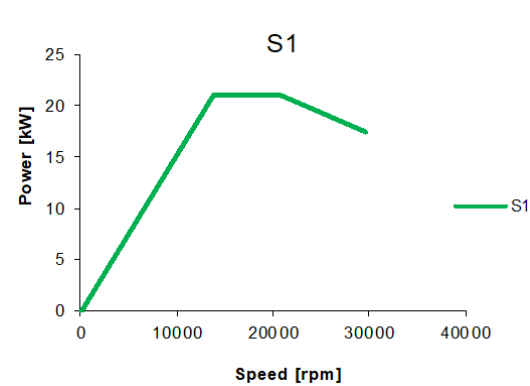
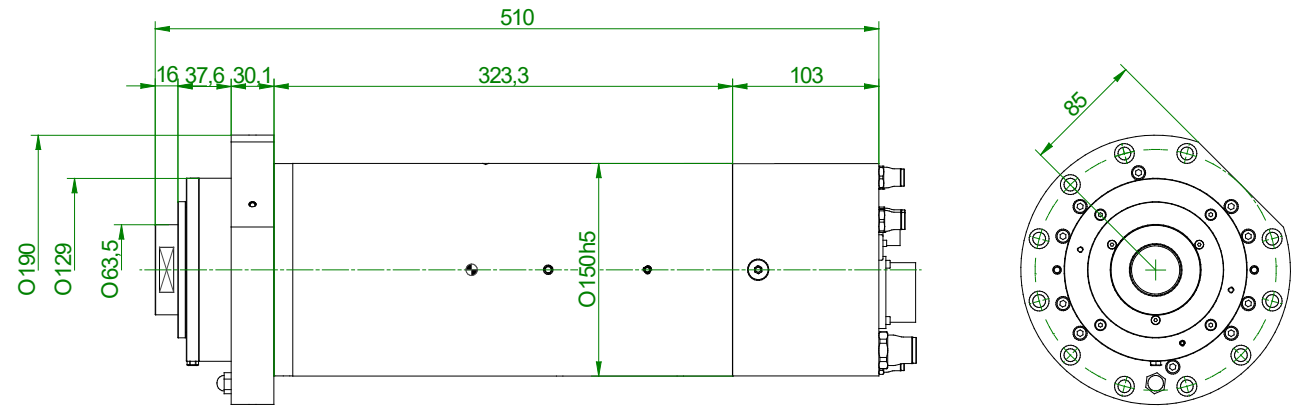



Precision Spindles &  
Spindle repair services

[myl.es](http://myl.es)

**Thank you**